



There's a . . . a



and a . . . a to
fit a surgical blade

D . ' de . . . a e fec c . . . ed e

Swann-Morton®
SHEFFIELD ENGLAND



UK
CA

All medical devices comply with the Medical Device Directive, 93/42/EEC as referred by Part I of the Medical Devices Regulations, 2002. Annex II (excluding section 4) as modified by Part 2 of Schedule 2A to the Medical Devices Regulations, 2002.



EMS 633531



ENMS 633525



FM 73368



Scan this code for more product information

SAFE HANDLING - PROCEDURES

Sa Ha -M Ba

The way in which a surgical blade is handled prior to use can determine how effectively it performs during use.

There are a number of ways that the cutting edge of a blade can become damaged once removed from its protective foil packet.

When removing a blade from the protective packet make sure it is not dropped into a metal bowl or container as this can reduce the initial keenness of the cutting edge even before it is fitted to the handle.

If you have to use forceps or needle holders to remove the blade from its protective packet ensure that you do not grip the blade across the cutting edge.

A ac a u ca ba

Use the following procedure to **a ac** a surgical blade:

- 1 Grip blade with forceps, or similar, avoiding contact with cutting edge.
- 2 Hold handle in left hand with bayonet fitting uppermost.



- 3 Place blade partway over handle fitting and engage slots.
- 4 Slide blade until it clicks into position.

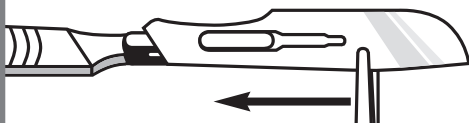

- 5 To improve assembly, flex blade slightly upwards when sliding onto the handle.



R a u ca ba

Use the following procedure to **de ac** a surgical blade:

- 1 Grip the blade with forceps or needle holders at point A making sure that the cutting edge is facing away from the hand and body.
- 2 Ensure the blade is pointing downwards and towards the trolley and NOT towards another member of your team.
- 3 Whilst holding the handle firmly lift the back edge of the blade with the forceps or needle holders and slide away the handle.

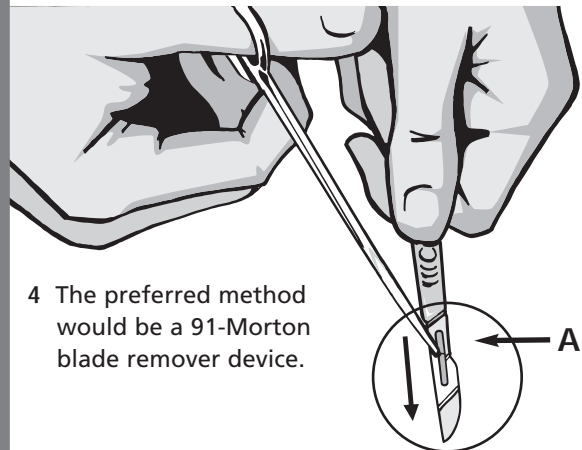

- 4 The preferred method would be a 91-Morton blade remover device.

DON'T DESTROY A PERFECT CUTTING EDGE

Blades should never be fitted to handles with damaged or worn fitments

91-Morton and the 'ring pattern' logo are registered trademarks of 91-Morton Limited and related companies. The products shown are manufactured for use by trained health care professionals and can cause injury if used or handled incorrectly. The information and illustrations used in connection with the products shown on this leaflet are for general guidance only and users must seek proper training and instruction in their use before using or handling such products. 91-Morton Limited exclude all liability for injury to the extent permitted by law.